

CONFERENCE HANDBOOK





The future is BHP Billiton. The future is yours.

We are BHP Billiton, the world's leading diversified resources company and among the top producers of major commodities. Our strategy is clear. We focus on investing in large, long-life, low-cost, expandable, upstream assets that are diversified by commodity, geography and market.

Excellence in geoscience is central to our exploration and resource development activities. We apply the latest multi-disciplinary technologies and equipment in the expert collection, interpretation, storage and retrieval of geoscience data.

With a global workforce of 41,000 employees and 58,000 contractors at 100 operations in 25 countries, we offer unparalleled opportunities to work across disciplines, geographies and cultures. Our people are the foundation of our business and underpin our success. Nothing is more important to our success than having talented and motivated people who start each day with a sense of purpose and end the day with a sense of accomplishment.

www.bhpbilliton.com



bhpbilliton
resourcing the future

From the Conference Organising Committee

Dear Conference Delegates, Sponsors and Exhibitors

On behalf of the Conference Organising Committee and the Australian Society of Exploration Geophysicists, we would like to welcome you to the 22nd International Geophysical Conference and Exhibition (ASEG 2012).

Without the support of our sponsors, we would not enjoy such successful conferences, and 2012 is no exception. We express our thanks and appreciation to the following key sponsors:

Platinum: BHP Billiton

Gold: AngloAmerican and Origin Energy

Silver: Beach Energy, Carpentaria Exploration Limited, CGGVeritas, GEOSOFT, Ion Geophysical Corporation, Petroleum GeoServices, Pitney Bowes Software, Talisman Australasia and Velseis.

Likewise, thanks to all our Bronze sponsors and conference supporters, as their input is equally valued.

Our conference theme is 'Unearthing New Layers', which recognises that innovative thinking can still produce transformational changes in our industry. This conference brings together a dynamic mix of domestic and international delegates representing industry, government and education, all of whom have interests in the application of geophysics. Such diversity is reflected in both the Technical Program and Exhibition Hall. Whether your interest is in the near surface or deeper strata, minerals or petroleum fields, engineering or environmental, exploration of our Technical Programme and Exhibition will show that this conference truly does unearth new layers.

So, for the duration of the conference and associated workshops, make sure you renew old acquaintances, make some new ones and take the opportunity to listen, learn and discuss geophysics, so that together we can fulfil the quest of 'Unearthing New Layers'.

Co-Chairs

Andrea Rutley Wayne Mogg
AngloAmerican Origin Energy

Conference Organising Committee

John Donohue, Exhibition
Carpentaria Exploration Limited
Ron Palmer, Sponsorship
PGC Group
Henk van Paridon, Publicity
GeoSolve Pty Ltd
Noll Moriarty, Finance
Archimedes Financial Planning Pty Ltd
Koya Suto, Workshops
Terra Australis Geophysics Pty Ltd
Binzhong Zhou, Technical
CSIRO
Margarita Pavlova, Secondary Students
Origin Energy
Cameron Hamilton, Postgraduate Students
Energeo
Sylvia Michael, Conference Proceedings
Geoimage Pty Ltd



BEACH ENERGY

Success through innovation
Delivering the energy of tomorrow

25 Conyngham Street
GLENSIDE SA 5065

GPO Box 175
ADELAIDE SA 5001

Tel: +61 8 8338 2833
Fax: +61 8 8338 2336

Web: www.beachenergy.com.au
Email: info@beachenergy.com.au

From the ASEG President

Welcome to Brisbane and the 22nd International Geophysical Conference and Exhibition. This year's conference is hosted solely by the Australian Society of Exploration Geophysicists (ASEG) with support from the Petroleum Exploration Society of Australia (PESA), The Society of Exploration Geophysicists (SEG) and the European Association of Geoscientists and Engineers (EAGE). The conference organising committee has arranged a great program including commercial exhibitors, three days of technical presentations and posters, with workshops occurring in the days immediately before and after the conference.

The theme of this year's conference is '*Unearthing New Layers*'. This theme emphasises a core part of exploration geophysics: ours is a science and industry of constant learning, testing, and risk-taking with occasional success in *unearthing* innovative new technologies and new resource plays. Witness the recent success and rapid spread of CSG in Australia (a new resource play) or reverse time migration (a new seismic technology). Conferences like this one are the best way that practising geophysicists can learn about the new emerging technologies and resource plays that are so important to our profession.

This year's technical sessions are spread over three days with five concurrent sessions each day. Two of these concurrent sessions will be focused on mineral geophysics, two will be focused on petroleum geophysics and the fifth session is a 'transition' session that sits

somewhere in between with topics including geothermal, groundwater, coal, near surface seismic, coal seam gas, and CO₂ sequestration.

The conference organising committee has made a conscious effort to increase the emphasis on petroleum topics and thus this year (for the first time) the number of petroleum sessions will equal the number of mineral sessions. For these petroleum sessions, one concurrent session will be focusing on interpretation and the other session on acquisition and processing. The organising committee has also been proactive in increasing the quality of the petroleum sessions by inviting 12 speakers, many of them international, each with expertise in the new technologies petroleum geophysicists will be most interested in.

This does not mean any lessening of our high standards for mineral geophysics. Australia is a world leader in mineral resource plays and Australian geophysicists are world leaders in developing and using innovative geophysical technologies for mineral exploration. I think you will find that this conference continues that grand tradition.

What is in this conference for the attendee? As mentioned above, exploration geophysics is continuously evolving. For a geophysicist to stay on top of all the new technologies and new resource plays requires much time and effort. And the well-organised and informative technical programs of the ASEG conferences provide a very

efficient way for geophysicists to see and learn about new technologies and resource plays. I also invite you to visit with the companies in the exhibition hall, learn what they are offering and how it might overlap with your exploration geophysics needs. Networking opportunities will also be competing for your time; a good geophysicist usually knows which colleague/service provider/consultant can provide the service or expertise that solves his/her geophysical needs. So plan your next three days well – there are over 200 technical presentations and posters to choose from as well as a full exhibition hall.

In closing, I would like to thank all of the people that make a conference like this work: the sponsors, presenters, exhibitors and organisers. And perhaps most importantly, to the attendees: go forth, learn, and enjoy! This is a conference for you – make the most of it!



Dennis Cooke
*President of the Australian Society of
Exploration Geophysicists*

The ASEG 2012 Conference Organising Committee wishes to acknowledge the following sponsors for their contribution to the Conference and continuing support of the industry

Platinum Sponsor

BHP BILLITON



BHP Billiton is the world's leading diversified resources company. Our purpose is to create long-term shareholder value through the discovery, acquisition, development and marketing of natural resources.

We are among the world's top producers of major commodities, including aluminium, energy coal, metallurgical coal, copper, manganese, iron ore, uranium, nickel, silver and titanium minerals, and have substantial interests in oil and gas.

BHP Billiton's strategy is to own and operate large, long-life, low-cost, expandable, upstream assets, diversified by commodity, geography and market. Our global operations comprise approximately 100 000 employees and contractors working across 100 operations located in over 25 countries.

BHP Billiton is committed to sustainable development in the communities in which we operate around the world. The safety

of our people and respect for the environment and the local communities is a key value for our Company.

BHP Billiton Limited has a primary listing on the Australian Securities Exchange and BHP Billiton Plc has a premium listing on the London Stock Exchange, with a secondary listing on the Johannesburg Stock Exchange. In addition, BHP Billiton has two American Depositary Receipt listings on the New York Stock Exchange. BHP Billiton's global headquarters are located in Melbourne, Australia.



BHP Billiton Mitsubishi Alliance

BHP Billiton Mitsubishi Alliance (BMA) is Australia's largest coal miner and exporter, and the world's largest supplier to the seaborne coking coal market.

BMA operates mines located in the coal-rich Bowen Basin of Central Queensland including:

- **Goonyella Riverside** (100% ownership)
- **Broadmeadow** (100% ownership)
- **Peak Downs** (100% ownership)
- **Saraji** (100% ownership)
- **Norwich Park** (100% ownership)
- **Gregory Crinum** (100% ownership)
- **Blackwater** (100% ownership)
- **Hay Point Coal Terminal**

Gold Sponsors

ANGLO AMERICAN



Anglo American's Metallurgical Coal business is one of Australia's largest producers and exporters of metallurgical coal, with extensive coal mining interests in Queensland and New South Wales, as well as the Trend metallurgical coal mine in British Columbia, Canada. We are committed to creating value from coal safely and responsibly, growing our business through our attractive project pipeline and investing in the communities in which we operate. A part of Anglo American, we are helping build the leading global mining company.

ORIGIN



Origin is the leading integrated energy company across Australasia. It has diverse operations spanning across the energy supply chain; from gas exploration and production to power generation and energy retailing. Origin has an extensive portfolio of exploration and new venture projects both on onshore and offshore.

Silver Sponsors

BEACH ENERGY LTD



Beach Energy Limited ('Beach') is an ASX200-listed oil and gas exploration and production company based in Adelaide, South Australia. Beach has interests in more than 300 exploration and production tenements globally, including Australia, Egypt, Tanzania and the USA. Production for FY11 was 6.6 million barrels of oil equivalent ('MMboe'), with 2P reserves of 77MMboe and 2C resources of 583MMboe. In 2012, the Beach drilling program will incorporate both conventional and unconventional targets, including the basin centred gas play in the heart of the Cooper Basin. Beach estimates this could contain in excess of 300Tcf of gas in place.

CARPENTARIA EXPLORATION



Carpentaria is an Exploration Company based in Brisbane and is East Coast focussed where the company believes there is still great potential for discovery of additional medium to large mineral deposits. The company listed on the ASX in November 2007.

In just over two and a half years Carpentaria's exploration has yielded two significant discoveries, Iron and Tin, made during the Global Financial Crisis rewarding their focused and aggressive exploration effort through that uncertain period. During this period Carpentaria entered into a number of Joint Venture agreements which maintained a healthy drilling budget and contributed to the success.

CGGVERITAS



CGGVeritas is the world's leading international pure-play geophysical company delivering a wide range of technologies, services and equipment to its customers across the global oil and gas industry.

Geophysical equipment is developed and marketed by Sercel. Geophysical services cover offshore and onshore seismic

acquisition, seismic data processing and imaging, as well as reservoir characterization. CGGVeritas also offers an advanced suite of seabed seismic services and owns a recent vintage, well positioned library of multi-client land and marine seismic data.

GEOISOFT



Earth scientists explore and make discoveries through data. Geosoft's mission is to make the explorer data experience simple, natural and powerful. Our promise is less time spent handling data and more freedom to explore. Every software solution we create and service we provide is focused on helping explorers keep pace with the demands of their data world. After 25 years, with offices across five continents, and a network of international business partners, Geosoft services thousands of organisations, including government geological surveys and agencies, educational institutions teaching the earth sciences, and the most successful oil and mineral explorers in the world.

ION GEOPHYSICAL CORPORATION



→ Charged to innovate. Driven to solve.™

ION Geophysical Corporation is a leading provider of geophysical technology, services, and solutions for the global oil & gas industry. ION's offerings allow E&P operators to obtain higher resolution images of the subsurface to reduce exploration and development risk, and enable seismic contractors to acquire geophysical data more efficiently. Visit iongeo.com.

PETROLEUM GEOSERVICES



Petroleum Geo-Services (PGS) is a leading, worldwide geophysical company providing an extensive range of seismic services and products for the petroleum industry including seismic data acquisition, processing, reservoir monitoring and analysis, interpretation and electromagnetic studies. The company also possesses the world's most extensive 3D MultiClient data library.

With its headquarters in Oslo, Norway, the company has over 34 offices worldwide in 25 different countries with larger regional offices in London, Houston and Singapore. The company is listed on the Oslo stock exchange (OSE: PGS).

PITNEY BOWES SOFTWARE



Pitney Bowes Software provides solutions and services for the discovery, evaluation, development and management of natural resources. Our solutions, coupled with our expertise in the geosciences, is used in mineral exploration, petroleum exploration, resource evaluation, coal and iron ore mining, industrial minerals, geotechnical engineering and environmental management. With our powerful visualisation and interpretation environments, we help to effectively manage resources, analyse data, reduce risk, maximise successes and deliver a superior return on technology investments.

TALISMAN ENERGY INC



Talisman Energy Inc. is a global, diversified, upstream oil and gas company, headquartered in Canada with regional offices throughout the world. Talisman's three main operating areas are North America, the North Sea and Southeast Asia. The company has a portfolio of international exploration opportunities including a gas aggregation project in Papua New Guinea managed by a team in Brisbane and Port Moresby. Talisman is

committed to conducting business safely, in a socially and environmentally responsible manner. Talisman is listed on the Toronto and New York stock exchanges under the symbol TLM. Please visit our website at www.talisman-energy.com.

VELSEIS



Velseis Pty Ltd is a highly experienced Australian seismic contractor, offering fully integrated seismic services to the petroleum, coal and mineral industries locally, as well as overseas.

Providing comprehensive 2D and 3D seismic acquisition services, Velseis utilises dynamite, Mini-SOSIE and 'Envirovibe' Vibroseis techniques. Besides these conventional techniques, they can also provide logistics for multi-component, heli-portable, and shallow marine data as well as providing a specialised shothole drilling service through its Seisdrill division.

With a highly experienced seismic processing division, Velseis delivers high-quality 2D and 3D onshore, transition and marine processing services to the petroleum and coal sectors.

Velseis maintains its competitiveness with a proactive commitment to research and development. The R&D division engages in focussed research projects, and provides technical support to production divisions.

Contact: www.velseis.com.au or Ph: +61 7 3376 5544
Acquisition: mreveleigh@velseis.com.au
Processing: kdrihl@velseis.com.au

Bronze Sponsors

ANGLOGOLD ASHANTI AUSTRALIA



AngloGold Ashanti, a global gold mining company, headquartered in Johannesburg, South Africa, has 20 operations on four continents and several exploration programmes in both the established and new gold producing regions of the world. We create value for our shareholders, our employees and our business and social partners through safely and responsibly exploring, mining and marketing our products. Our primary focus is gold and we will pursue value creating opportunities in other minerals where we can leverage our existing assets, skills and experience to enhance the delivery of value.

NEWMONT MINING CORPORATION



Newmont Mining Corporation is a leading gold producer with operations on five continents and is also engaged in the exploration for and acquisition of gold properties in some of the world's best gold districts. It employs approximately 34 000 employees and contractors worldwide.

Newmont owns or has an interest in three Australian gold mining operations and is nearly finished with constructing the expanded Boddington gold mine 130 km southeast of Perth. The Kalgoorlie Consolidated Gold Mines (KCGM) Super-Pit at Kalgoorlie is 50 percent owned by Newmont, as part of a joint

venture with Barrick Gold Corporation; Kalgoorlie Consolidated Gold Mines (KCGM) operates the mine. The Super Pit is the biggest gold open pit mine in the country and produces more than 25 tonnes of gold every year, far outweighing any other gold mining centre in Australia.

Website: www.newmont.com

OUTER-RIM EXPLORATION SERVICES PTY LTD



Outer-Rim Exploration Services Pty Ltd, a 100% Australian owned company, was established in 1993 to conduct Pulse EM surface and downhole surveys using the Crone time domain system. The Crone PEM system was chosen because of its portability, reliability and, most importantly, consistency of data. This, combined with the Company's experienced and dedicated personnel, and their professional approach to data collection, has led to ORE's rapid growth and enviable reputation within the global geophysical survey industry.

Outer-Rim Exploration Services has one of the industry's strongest operational teams and has the ability to conduct geophysical survey operations safely and efficiently anywhere on the planet.

PLANETARY GEOPHYSICS PTY LTD

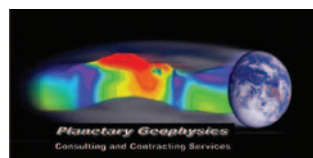

Planetary Geophysics, based in Toowoomba, Queensland specialises in the acquisition, processing and interpretation of ground based mining geophysical surveys. Since its founding in 2005 the company has undertaken IP/resistivity, gravity, ground magnetic and electromagnetic surveys in many countries in Africa, Asia, Australasia and Europe. Please visit our website, www.planetarygeophysics.com.au.

QUANTEC GEOSCIENCE



Quantec Geoscience is a global integrated geophysical services and consulting group, providing survey design, data acquisition, data processing, interpretation and inversion services. With a focus on data quality, safety, productivity and the environment, Quantec has been delivering professional services for 25 years throughout Australia and internationally.

Quantec Geoscience delivers deep imaging services for mineral; oil and gas; and geothermal exploration using proven technologies – Titan 24 Deep Earth Imaging, Quantec Ground Geophysics, and Spartan Magnetotelluric (MT) Imaging. With more than 2500 surveys over 25 years, Quantec is a global leader in deep exploration and discovery.

RIO TINTO



Rio Tinto Exploration is a global operation dedicated to discovering new mineral resources to replace and/or supplement those already mined by the Rio Tinto Group. The exploration process can be long and complex, involving the use of highly sophisticated technology and equipment often in remote locations and under challenging conditions.

Divided into five geographic regions covering Australasia, Asia, Africa/Europe, North America and South America, Rio Tinto Exploration is a cutting-edge business unit. Since 1994 exploration has resulted in new finds of nickel, diamonds, potash, copper and gold. Exploration teams – along with a small Project Generation team – are constantly seeking new finds of these important products plus deposits of bauxite, iron ore, coal, uranium, borate and other industrially viable minerals.

PIRSA



Government of South Australia

Department for Manufacturing, Innovation, Trade, Resources and Energy

The Resources and Energy Group, is part of the South Australian Government's Department of Manufacturing, Innovation, Trade, Resources and Energy (DMITRE). It provides a wide range of regulatory, promotional and advisory services to the minerals, mining, petroleum and geothermal industries. This includes gathering and value-added geoscientific datasets for delivery to the exploration industry and wider public. Many databases – including geophysical data – can be accessed and downloaded via the South Australian Resources Information Geoserver (SARIG: <https://sarig.pir.sa.gov.au/>).

Pen Sponsor



Writing Pad Sponsor





WE'RE LOOKING FOR FUTURE ENERGY RESOURCES. YOU.

At Origin, we're an Australian company focused on meeting growing energy demands.

It's a big job and we've already grown to be over 4,400 strong, across energy exploration, production and retailing.

And we reckon that's just the beginning.

We need energetic and highly skilled people to help us create a bright future. In fact, you could be exactly who we're looking for.

Why not join us?

[ORIGINENERGY.COM.AU/CAREERS](https://originenergy.com.au/careers)

Brisbane Convention and Exhibition Centre Ground Floor

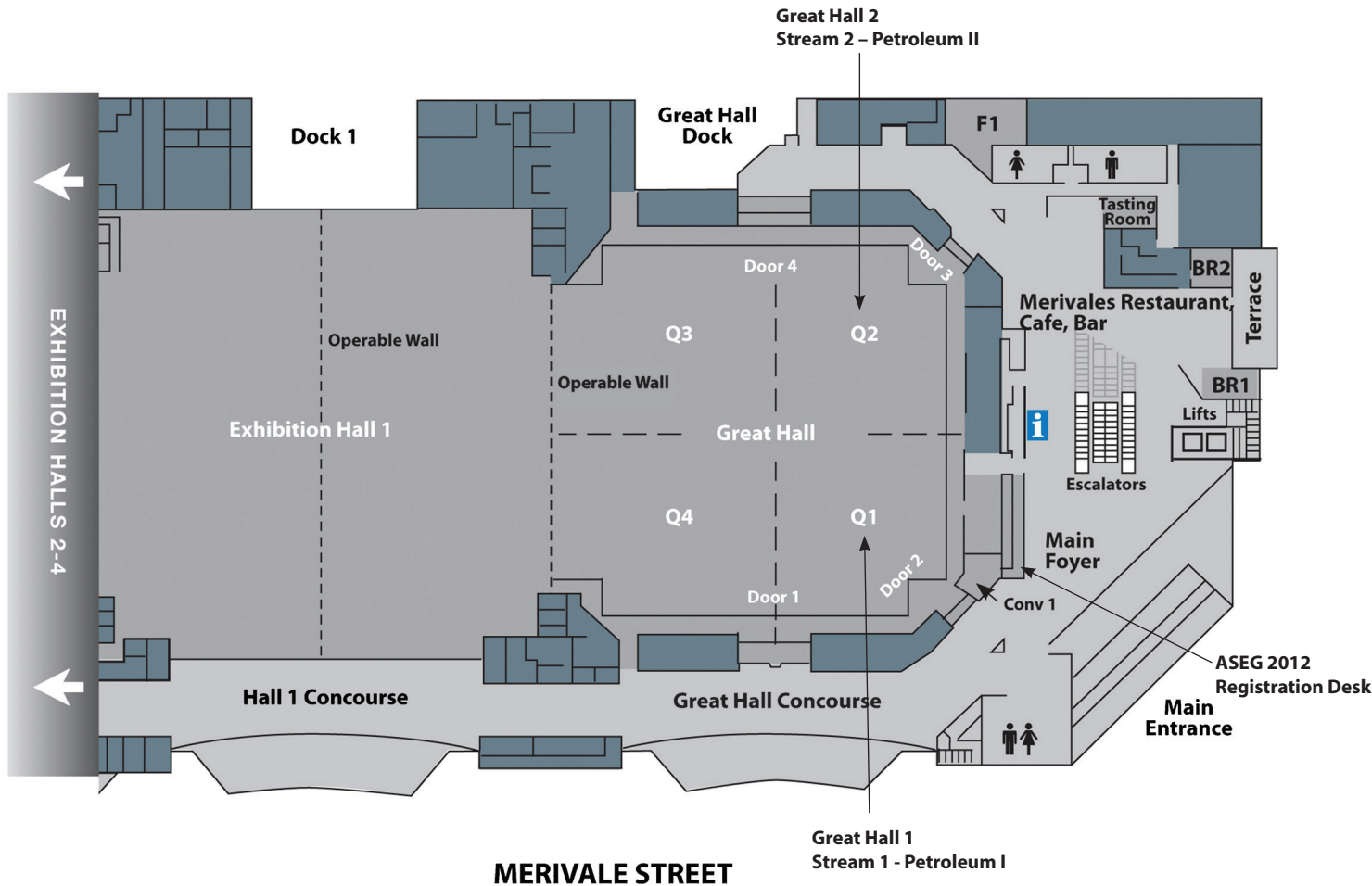

Brisbane Convention and Exhibition Centre Mezzanine Floor

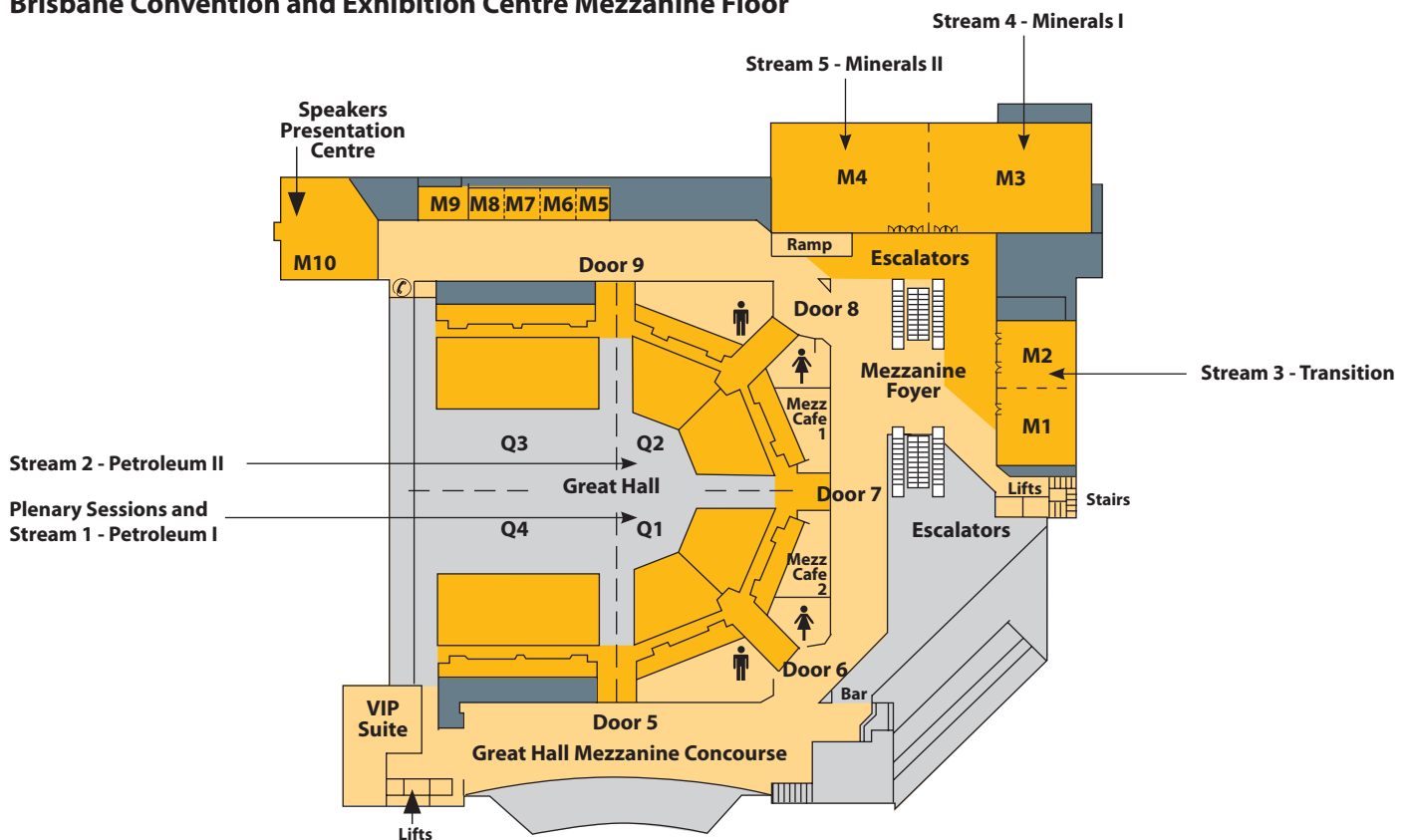

Conference Venue

Brisbane Convention and Exhibition Centre
Cnr Merivale and Glenelg Streets
South Bank, QLD 4101, Australia
Phone: + 61 7 3308 3000
Website: www.bcec.com.au

Conference and Exhibitions Managers

22nd International Geophysical Conference
and Exhibition Managers



arinex pty limited
Level 5, 79 Adelaide Street
Brisbane, QLD 4000, Australia
Phone: + 61 7 3226 2800
Fax: + 61 7 3226 2899
Email: aseg2012@arinex.com.au
Website: www.aseg2012.com.au

arinex pty limited has been appointed as the official PCO (Professional Conference Organiser) and looks forward to delivering an inspiring experience for ASEG 2012.

Registration Desk

The Registration Desk is located in the Ground Floor Foyer of the Brisbane Convention and Exhibition Centre and will be operating at the following dates and times:

Sunday 26 February 2012	1700–1900
Monday 27 February 2012	0700–1700
Tuesday 28 February 2012	0730–1700
Wednesday 28 February 2012	0730–1600

Name Badges

Each delegate registered for the Conference and Exhibition will receive a name badge at the Registration Desk. This badge will be your official pass and must be worn to obtain entry to all sessions, the exhibition and social functions.

Speakers Preparation Room

The Speaker Preparation Room is located in Meeting Room 10 (Mezzanine Level) at the Brisbane Convention and Exhibition Centre. All speakers will have access to the Speaker Preparation Room on the following days and times:

Sunday 26 February 2012	1700–1900
Monday 27 February 2012	0700–1700
Tuesday 28 February 2012	0730–1700
Wednesday 28 February 2012	0730–1500

Speakers must visit the Speakers Preparation Room at least 24 hours prior to the start of their session to ensure their presentation(s) are loaded successfully.

Poster Presentations

Proudly sponsored by



Posters will be displayed in the Exhibition Area in Hall 1. Posters will be displayed for the duration of the Conference and Exhibition.

Messages

All messages received during the Conference and Exhibition will be placed on the Message Board located next to the Registration Desk. To collect or leave messages please visit the Registration Desk.

Catering

Morning and Afternoon Tea

Lunch

Proudly sponsored by

Proudly sponsored by



Morning tea, lunch and afternoon tea will be served in the Exhibition Area, Hall 1. Catering will be served at the following dates and times:

Monday 27 February 2012	
Morning Tea	1030–1100
Lunch	1230–1330
Afternoon Tea	1500–1530
Tuesday 28 February 2012	
Morning Tea	1030–1100
Lunch	1230–1330
Afternoon Tea	1500–1530
Wednesday 29 February 2012	
Morning Tea	1030–1100
Lunch	1230–1330
Afternoon Tea	1530–1600

Special Dietary Requirements

If you have notified the Conference and Exhibition Managers of any special dietary requirements, please be advised that this information has been supplied to the Brisbane Convention and Exhibition Centre. It is requested that you make yourself known to the venue catering staff during meal breaks.

Internet Centre

Proudly sponsored by

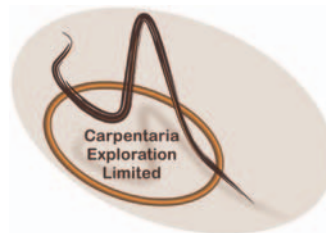

The Internet Centre will be located in the Exhibition Area, Hall 1 for delegates to use throughout the Conference and Exhibition.

The Internet Centre will operate during the following dates and times:

Sunday 26 February 2012	1700–1900
Monday 27 February 2012	0830–1830
Tuesday 28 February 2012	0830–1830
Wednesday 28 February 2012	0830–1600

Internet Wireless

In addition to the Internet Centre all delegates have access to the Brisbane Convention and Exhibition Centres free wireless internet service. The free service is available between 7:00 am and midnight and allows basic Internet and Email access. Corporate VPN is not possible on the free service.

To connect to this free service, choose the wireless network called 'BCEC-Link' from the wireless networks list. Then start a web browser session and accept the terms and conditions to start browsing.

Photography

By registering to attend ASEG 2012 you grant the Conference Organising Committee permission to both photograph and video record you during Conference and Exhibition activities. This footage may be used in relation to future ASEG Conference and Exhibitors and for ASEG usage.

Disclaimer

The Conference and Exhibition Managers, the Conference Organising Committee and ASEG will not accept liability for damages of any kind sustained by participants or their accompanying persons or loss of or damage to their personal property as a result of the conference or related events. The conference program is correct at the time of printing, though the Conference and Exhibition Managers reserve the right to make necessary change to programming. Receipt of delegate registration acts as acceptance of this disclaimer. Some scheduled events are subject to minimum numbers and we reserve the right to amend or cancel the proposed events if minimum numbers are not met.

Privacy Statement

Australia introduced the Privacy Amendment (Private Sector) Act 2000 in 2001. The Conference and Exhibition Managers comply with this legislation, which is designed to protect the right of the individual to privacy of their information. Information collected in respect of proposed participation in any aspect of the Conference and Exhibition will only be used for the purposes of planning and conduct of the Conference and Exhibition and may also be provided to the organising body or to organisers of future events. It is also usual to produce a 'Participant/Delegate List' of attendees at the Conference and Exhibition and to include the individual's details in such a list. Consent for publication of the individual's information has been withheld when completing the Registration Form for the Conference and Exhibition.

Accommodation

Following are the addresses, phone and fax numbers of all official Conference Hotels. Below is a Map of Brisbane CBD to help you to find your hotel. Enquiries concerning accommodation can be made at the Registration Desk.

1. Rydges Southbank

9 Glenelg Street
South Bank, QLD 4101, Australia
Phone: + 61 7 3364 0800

2. Mantra Southbank

161 Grey Street
South Bank, QLD 4101, Australia
Phone: + 61 7 3305 2500

3. Hotel George Williams Brisbane

317–325 George Street
Brisbane, QLD 4000, Australia
Phone: + 61 7 3308 0700

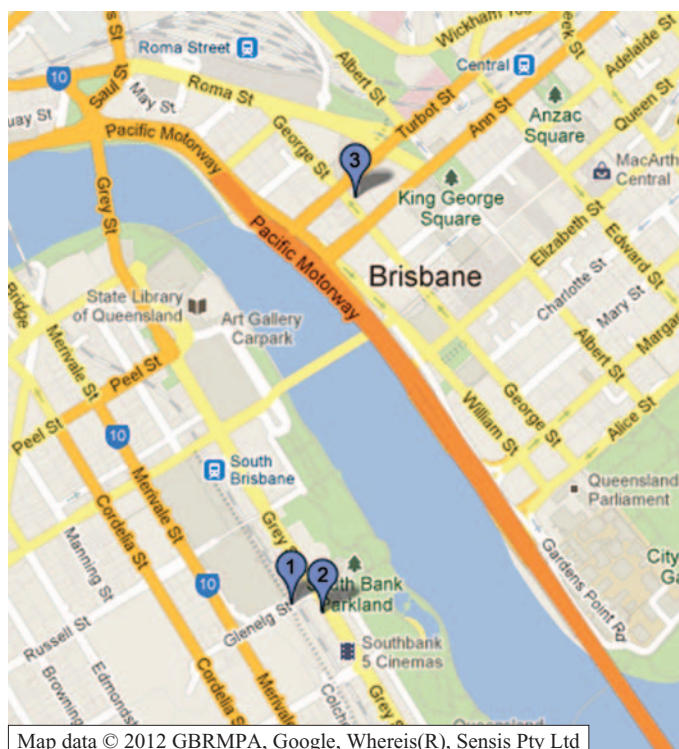

Map data © 2012 GBRMPA, Google, Whereis(R), Sensis Pty Ltd

ASEG 2012 Hotels

- 1 Rydges South Bank Brisbane Hotel
- 2 Mantra South Bank
- 3 Hotel George Williams

Airport and Transport

Brisbane's International and Domestic Airports are located approximately 25 minutes drive (13 km) from Brisbane's CBD.

Whether you are an international or interstate visitor, there is a large range of accessible, reliable and cheap transportation options, including shuttle buses, Airtrain, taxis, car rental and hotel transfers to and from the CBD.

Shuttle buses

If you are concerned about the amount of luggage you have accumulated during your stay in Brisbane, shuttle buses are a convenient, fast and comfortable way of travelling to and from the Airport.

Services from Brisbane City operate daily every 30 minutes from 5:00 am to 9:00 pm from Roma Street Transit Centre and door to door of all CBD hotels.

If leaving from Brisbane Airport, buses depart every 30 minutes from 5:30 am to 11:00 pm. All bus services meet flight departure and arrival times so you'll always be on time. If you miss one, wait just half an hour for the next service.

For information call Coachtrans on (07) 3238 4700.

Airtrain

For single travellers on the go, the Airtrain, operating 5:00 am to 9:00 pm 7 days a week, is probably the most time-efficient option.

If you are in a hurry and require a direct line from the Airport to the City, jump aboard for a quick 22 minute train trip!

Stations are conveniently located near most CBD accommodations and attractions. For online bookings visit www.airtrain.com.au.

Taxis

For service with that personal touch, wait for one of Brisbane's friendly and reliable taxi drivers to transfer you to your hotel.

At Brisbane Airport's Domestic Terminal, taxi ranks are located at both the Qantas and Virgin Blue ends of the terminal. For the International Terminal, taxi ranks are available on Arrivals Level 2.

All Brisbane taxis have standard taxi meters so you won't have to worry about being stung by overpriced fares. Keep in mind that a fare to Brisbane CBD is approximately \$45 plus a small fee for departing taxis only. Go to www.brisbaneairport.com.au for more information about Airport travel.

Looking for a number? Black and White Cabs: 131 008, Yellow Cab: 131 924.

Car rental

There is a host of car rental companies in Brisbane with tidy, reliable and economical cars to suit all travel needs. For more information, call Brisbane Marketing on (07) 3006 6200.

Hotel transfers

Many Brisbane hotels provide coach transfers to and from the airport. Just ask the hotel representative when making your reservation. All you need is your flight itinerary; it's that easy! Important note: International and interstate visitors should allow approximately 20–30 minutes for processing through customs. In peak periods, waiting times may increase slightly.

Aarhus Geophysics 

FROM DATA TO KNOWLEDGE

CONSULTING in Airborne Electromagnetics
SOFTWARE for processing and inversion of Geophysical data

Aarhus Geophysics offers state of the art consulting in airborne electromagnetics and unique software products for handling, processing and inversion of geophysical data.

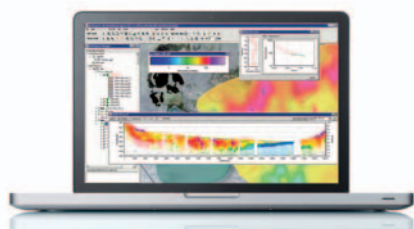

www.aarhusgeo.com





SAFE DISCOVERY

Any field Geoscientist will tell you that exploration is ultimately all about discovery.

At Anglo American however we believe that to be sustainable, exploration needs to be about safe discovery. Safe for our people, safe for the communities we work in, safe for the environments we explore. Today, discovering major ore bodies means exploring in harsher conditions for deeper deposits. Combining traditional field work with world-leading technologies to detect buried mineralisation has been key to our successful safe discovery of many major green and brownfield deposits.

Anglo American is one of the world's largest diversified global mining companies. We have significant interests in a wide range of commodities. We are committed to Australia with an active exploration team based in Perth and our Metallurgical Coal business is headquartered in Brisbane, Australia, with mines in Queensland and New South Wales, an operation in Tumbler Ridge in British Columbia, Canada and an exciting programme of growth projects.

We have the scale, people and resources to make Safe Discovery and operation a reality for the next generation of Exploration Geoscientists.

Discover our difference: www.angloamerican.com



Real Mining. Real People. Real Difference.